

C-206-12

230

pat-
A-6-109

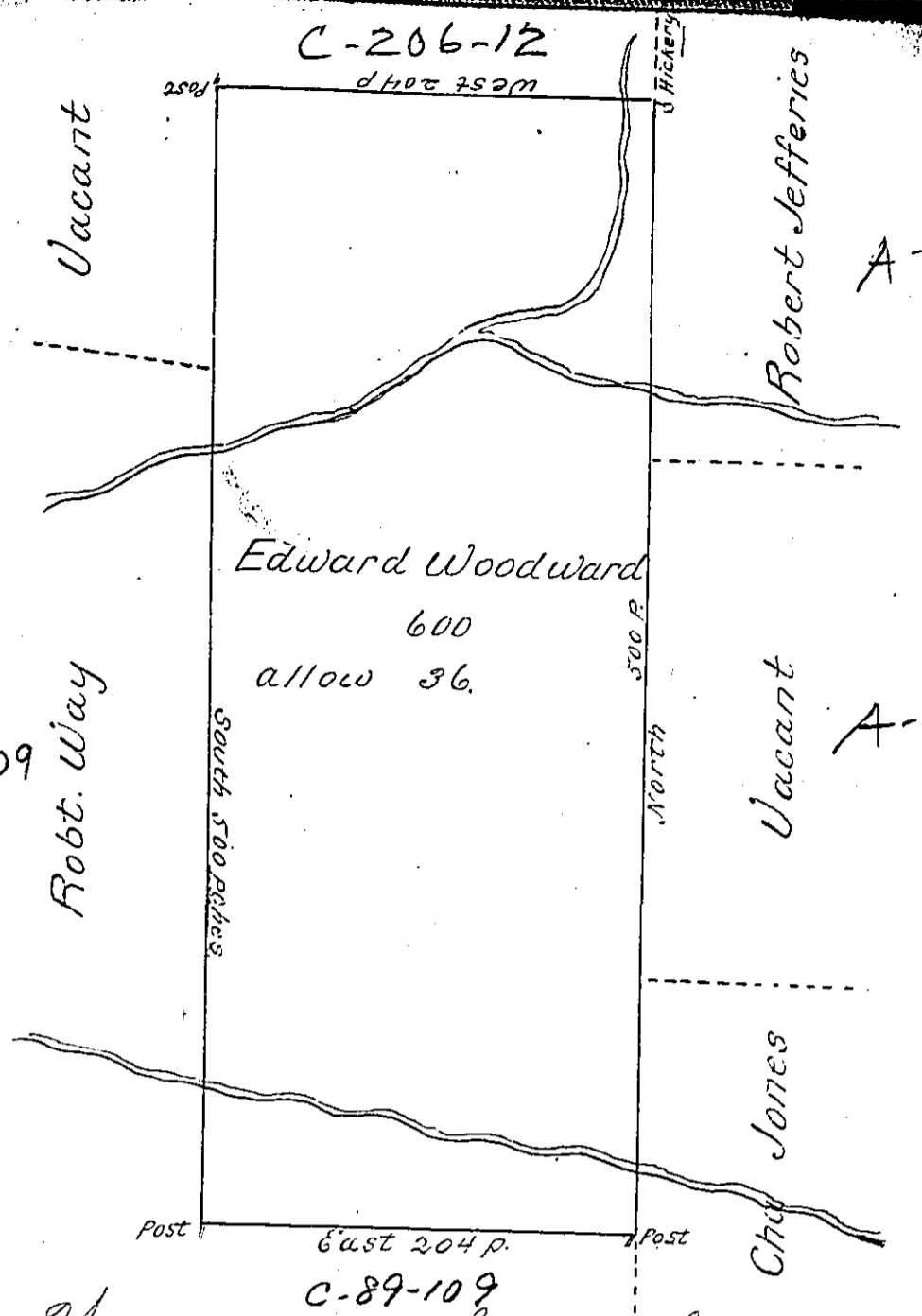

C-89-109

Edward Woodward's Land Situate on the Mill Creek (being a Branch of Conestogoe) in the County of Chester Begins at a Hickory in a line of Robert Jefferies's land thence west by vacant land 204 pches to a post thence by Vacant Land & the Land of Robt. Way South 500 pches to a post thence East by Vacant land 204 pches to a post thence North by the Land of Charles Jones Vacant Land and the land of the sd. Robert Jefferies 500 pches to the place of Beginning containing Six hundred acres & the allowance of Six acres plus or minus

204	
500	
10200	1636
628	

The above described Tract of Land was Survey'd by Isaac Taylor the 12th of May 1715 by James Steel's order of the 8th of the same month & sold Woodward having sold his Right to Nathl Verman The Proprietaries ordered this to be returned to Nathl Verman in pursuance of their Warrant dated the 14th day of Janry. 1734.

Returned into the Secretary's office the 12th day of February 1734.

IN TESTIMONY that the above is a copy of the original remaining on file in the Department of Internal Affairs of Pennsylvania, made conformably to an Act of Assembly approved the 16th day of February, 1833, I have hereunto set my Hand and caused the Seal of said Department to be affixed at Harrisburg, this fifth day of March 1901

James W. Latta
Secretary of Internal Affairs.